

# MATERIALS HANDLING

## SKATE WEIGHTS

NEW



See stage weights on page 152

**Weight Skate XL** Flints is synonymous with Stage Weights but we haven't ever stocked anything to help you move them around... but now we have the Weight Skate; designed to carry up to 24 stage weights with a welded steel frame that weights neatly stack into. Think of this like a very fancy and much safer dolly. The

frame extends on two sides for you to have a two handed grip whilst manoeuvring. Great for moving weights around but also a compact weight storage frame with heavy duty braking castors and a black finish, so can be discretely stowed away backstage. The Weight Skate can also be customised with your own logo if you wish, please get in touch with us for a quote!

Specification: Dimensions: 53cm (W) x 52cm (H) x 54cm (D)

Weight Skate XL	code	price
Weight Skate XL	FHS023WSXL	£400.00
Weight Skate XL + 20 Stage Weights	FHS023WSXLK	£995.00

## PANEL CARRIERS



**Panel Carrier – The Original** Transforms lifting heavy panels into an effortless task due to a clever ergonomic design. The cams quickly [and gently] lock onto any panel up to 65 mm thick at a comfortable handling height. This prevents having to bend down to get your fingers under heavy panels and saves your back from undue strain. The comfy handgrip protects your hands from sharp

edges and splinters. This particular design can also grip the top of narrow panels which panel lifters, with a single central leg, are unable to do.

☐ Supplied in a box with: two handles. Red rubber handle.

Panel Carrier	Load limit	takes panels	code	price
Per pair	75 kg	65 mm	TOLZKH01	£128.45

## PLATE SKATES

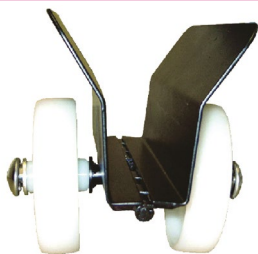

**Plate Skates** These useful devices will grip panels up to 56 mm thick and take loads of 250 kg on their strong 150 mm Ø wheels. Ideal for moving heavy flattage or sheets of ply from lorries or around stage. Just use one in the centre of the panel and the crew can manoeuvre heavy items with ease.

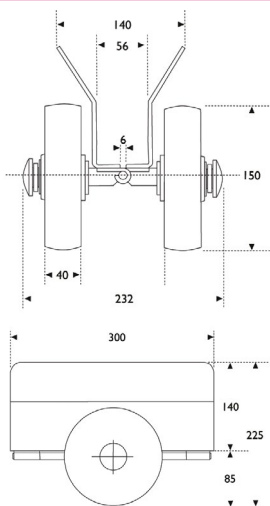

Plate Skates	capacity	takes panels	code	price
	250 kg	56 mm	CASPS15056	£60.90

## RATCHET STRAPS



F



50 mm width has these handles.

**Rubberised Handle Ratchet Straps** Very well made 8 m ratchet straps with a comfortable easy to use handle mechanism. We like them.



25 mm width has handles like this.

SPECIFICATION: Breaking strain: 25 mm = 1.5 tonnes, 50 mm = 5 tonnes.

Ratchet Straps	code	price	10+
length width end fittings			
8 m 25 mm Endless	RS25RE	£7.78	£6.95
8 m 25 mm Claw Hooks	RS25RC	£7.58	£6.90
8 m 25 mm Delta	RS25RD	£7.58	£6.90
8 m 50 mm Endless	RS50RE	£13.21	£11.63
8 m 50 mm Claw Hooks	RS50RC	£15.41	£13.55
8 m 50 mm Delta	RS50RD	£15.41	£13.55



**Tie Off Webbing** Soft and flexible, this webbing is ideal for securing scenery in trucks when ratchet straps are not suitable. Made from 1 mm thick white polyester. For other Polyester Webbing see page 208. For Roping Eyes see page 252.

Tie Off Webbing	width	Min BL	code	per m	100 m+
	25 mm	1,300 kg	ROPBW	£1.59	£1.00

## ROLLER CROW BAR



**Roller Crowbar** Essential equipment for fitting-up heavy steel scenery and trucks whilst aligning bolts or servicing castors. Now fitted with 75 mm diameter steel rollers. For other Crowbars see page 305.

SPECIFICATION: Handle length: 2 m. Load capacity: 1.5 tonnes. Max skate height: 145 mm. Weight: 13 kg.

Roller Crowbar	code	price
	CAS800	£163.90



**Low Plate Roller Crowbar** This model has a heavy-duty fabricated flat plate giving it a low profile, enabling it to get right under heavy scenery with little ground clearance. Fitted with 70 mm diameter steel rollers.

SPECIFICATION: Handle length: 1.5 m. Load capacity: 5 tonnes. Weight: 11 kg.

Low Plate Roller Crowbar	code	price
	CASV4402	£112.85

Capable of lifting loads up to 5,000 kg!

## SACK TRUCKS



**Heavy-Duty Folding Sack Trucks** A versatile sack truck which is strong and robust. Fully welded tubular steel, epoxy coated. The toe folds up for easy storage.

SPECIFICATION: Max load: 200 kg. Dims: 960 mm high x 500 mm wide. Foot size: 310 x 330 mm deep. Wheels: 200 x 50 mm. Weight: 10 kg.

Folding Truck	code	Tradeline
	TS182H	£152.78



**Stair Climbing Trolley** The foot folds up allowing it to be stored or carried in the boot of a car. We recommend the use of a ratchet strap when shifting items like driers or washing machines.

SPECIFICATION: Max load: 150 kg [50 kg on stairs]. Foot iron size: 355 x 395 mm deep. Wheels: 160 mm x 40 mm rubber tyre plain bearing wheels. Weight: 20 kg.

Stair Climbing	code	Tradeline
	TS160Y	£140.30



**Compact Folding Trolley** This is a useful and well made compact trolley for transporting loads of up to 50 kg. The wheels automatically fold flat for slim storage. It comes with a 1,060 mm bungee cord to help secure goods.

SPECIFICATION: Max load: 50 kg. Dims [when folded]: 670 x 336 x 100 mm. Wheels: 100 mm Ø. Weight: 2.75 kg.

Compact Trolley	code	price
	SAFTTB	£44.75

## VIKING ARM



**Viking Arm** This reversible squeeze trigger clamp that can be used to pry things apart or forcibly bring them together. Used in the construction industry for the installation of windows and doors we think this ingenious tool is great for installing castors. Each arm has 150kg lifting capacity so if set on 4 corners it's a powerful squeeze trigger jack. To reverse simply unscrew bolt at the top of the clamp and reverse the handle.

There are also 2 options for release of the clamp, full release or a gradual allowing for fine adjustment both release buttons are located at the back of the handle.

SPECIFICATION: Made from Stainless Steel/Hardened Carbon Steel/Aluminium. Lifts: from 7 to 215mm. Base Size: 105 x 87mm (6 mm thick plate)

Viking Arm	code	list	price
	TOLVM	£162.00	£149.00

## PLANKFORM™



Watch the video!

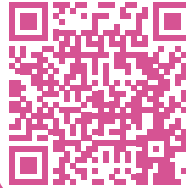

Shorten the legs for a bench to sit and have a cuppa.



**PlankForm™** Alasdair Flint's brainchild, PlanKForm™, spawned from a need for trestle tables which could be stored in a small space, be transported easily, and have endless uses. Simply slot a scaffolding board of your desired length [38 mm x 225 mm] through two PlanKForm™ units and it will transform your plank into a platform. The legs are simply four scaffolding tubes of the same length. You can create anything from a low bench to a 7' frame for a swing.

- ✓ Easily fits in the boot of your car
- ✓ Extremely versatile! Use any length of scaffolding plank and tube
- ✓ The horizontal bar between the sockets is perfect for hanging items like tools or a paint kettle
- ✓ Wingnuts threaded into the sockets keep the trestle secure and stable.
- ✓ Create multiple trestles to create a supporting surface to work on.

Available as just the PlanKForm units alone, or as a kit to make a work surface as shown above measuring 900 mm high, 985 mm long, and 225 mm wide. The kit includes:

- 1 pair of basic units [1 per end]
- 4 x 900 mm size 8 Aluminium Scaff legs [complete with end caps]
- 1 x Scaff board [38 x 225 x 985 mm]

PlankForm™	code	price
Plankform basic units alone	FHSPKF	£33.29
Plankform Kit - inc 4 legs + board	FHSPKFK	£71.00

## TOUGH TRUCKS



**Rough Terrain Turntable Truck** Multi-purpose trucks ideal for unloading flight cases and tool boxes from lorry to stage. Tubular steel surround with safe radius-ed corners and aluminium top. The handle springs up to vertical position when not in use. Ball bearing turntable and 250 mm Ø cushioned wheels.

SPECIFICATION: Max load: 500 kg. Platform size: 1,000 x 650 mm. Weight: 36 kg.

Turntable Truck	capacity	code	list	Tradeline
	500 kg	GP717J	£563.10	£499.00